

MALTA TOWNSHIP SECTION 29 R-12 TWP-10 MORGAN COUNTY, OH

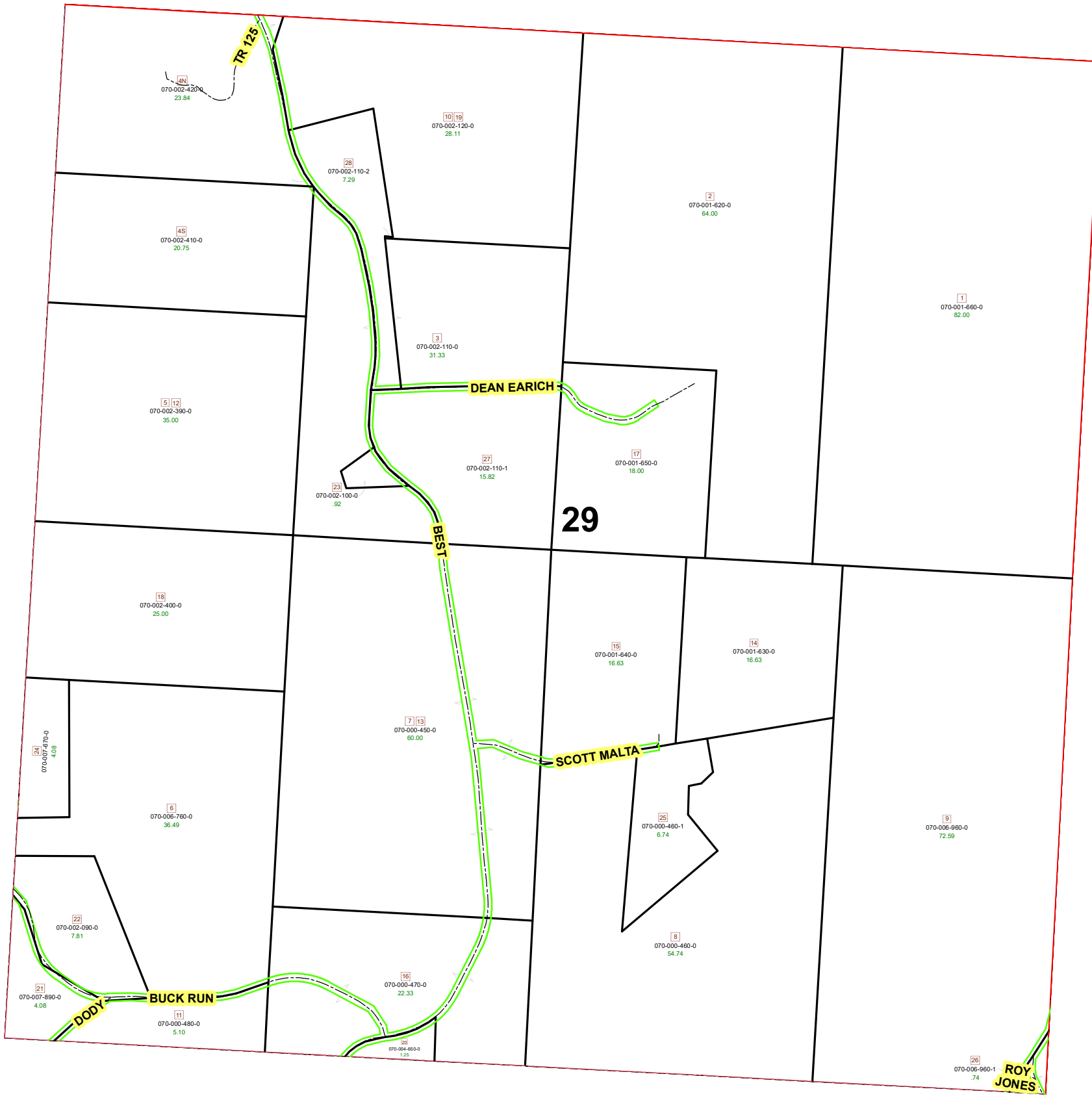

PIN	VOL	PAG	Owner	LegalDescr	Acres
070-000-480-0	OR229	1481	BEST FAMILY FARMS LLC	R12 T10 S29 SD 11	5.1
070-000-470-0	OR229	1481	BEST FAMILY FARMS LLC	R12 T10 S29 SD 16	22.33
070-000-460-0	OR104	318	BEST FAMILY FARMS LLC	R12 T10 S29 SD 8	52.742
070-000-450-0	OR104	318	BEST FAMILY FARMS LLC	R12 T10 S29 SD 7-1	60
070-000-460-1	D.V 194	314	BEST STEVEN C & THERESA JO	R12 T10 S29 SD 25	6.748
070-002-110-1	OR206	3118	BOWMAN LORRIE	R12 T10 S29 SD 27	15.824
070-001-660-0	D.V 203	775	EARICH BARRY & DEBBIE	R12 T10 S29 SD 1 S	82
070-001-650-0	OR222	416	EARICH BARRY & DEBBIE	R12 T10 S29 SD 17	18
070-001-620-0	OR222	416	EARICH BARRY & DEBBIE	R12 T10 S29 SD 2 S	64
070-002-110-0	OR206	3147	FUNK CHRIS	R12 T10 S29 SD 3	31.331
070-002-120-0	OR206	3147	FUNK CHRIS	R12 T10 S29 SD 10-	28.119
070-002-100-0	D.V 168	745	FUNK CHRIS A & LYDIA M	R12 T10 S29 SD 23	0.928
070-002-090-0	D.V 149	145	FUNK CHRIS ALLEN	R12 T10 S29 SD 22	7.81
070-002-420-0	OR59	610	GARBER FRED B & MARTA L	R12 T10 S29 SD 4 S	23.847
070-002-400-0	OR115	299	GLADDEN FAMILY LLC	R12 T10 S29 SD 18	25
070-002-390-0	OR115	299	GLADDEN FAMILY LLC	R12 T10 S29 SD 5-1	35
070-002-410-0	OR115	299	GLADDEN FAMILY LLC	R12 T10 S29 SD 4 S	20.75
070-002-110-2	OR206	3121	HARPER GRETCHEN	R12 T10 S29 SD 28	7.298
070-006-960-1	OR138	63	HARRIS JOHN E	R12 T10 S29 SD 26	0.74
070-007-670-0	OR96	582	HREHA MICHAEL A	R12 T10 S29 SD 24	4.088
070-006-960-0	OR228	547	KING LESLIE & TERRY	R12 T10 S29 SD 9	72.591
070-004-650-0	OR232	2962	KULLMAN JONATHAN P & JESSIE A	R12 T10 S29 SD 20	1.25
070-001-630-0	D.V 185	629	LAHMERS STEVEN E & SANDY J	R12 T10 S29 SD 14	16.63
070-001-640-0	D.V 185	629	LAHMERS STEVEN E & SANDY J	R12 T10 S29 SD 15	16.63
070-006-760-0	OR201	239	LITTERAL KRISTY L	R12 T10 S29 SD 6	36.49
070-007-890-0	OR91	132	WILSON WAYNE T	R12 T10 S29 SD 21	4.08

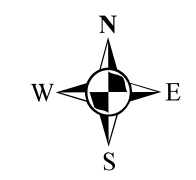

Boundaries	
-----	Hidden
-----	Roads
-----	County
-----	Parcel
-----	Parcels
-----	Hydro
-----	Lot
-----	Township
-----	Section
-----	ROW

Source: Morgan County Engineer's Office
 Author: Marcia Wolfe
 Date: 6/24/2020

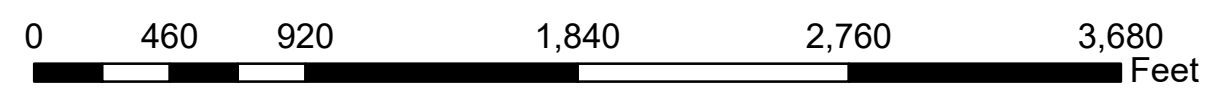

Disclaimer: The information that these maps contains is for reference purposes only. Please bring any errors to the attention of the Engineer's Office staff.
 Thank you